

**Technische Ausstattung**  
**Technical Equipment**

---

1. Venue Informations
2. Audio Equipment
3. Lighting, Video Equipment
4. Lighting Plan

## Venue Informations

### Stage:

- size: 7x7x0,6m
- surface: dance floor 'Consor black'
- current: stage left: 2x 16A schuko  
stage center: 2x 16A schuko  
stage right: 2x 16A schuko
- curtains: left/right: no curtains  
back left/back right: 1/3 of stage
- walls: black, rough surface

### Spectator Area:

- stand: 83 seats
- gallery: 32 seats

### Audio:

- remote control via Ipad available

## Audio Equipment

qty		item	info	
1	Mixer	Allen&Heath SQ5	16 x analog XLR in 12 x analog XLR out	
1	Mixer	Allen&Heath ZED14	6 x mic/line in 4 x stereo in	
1	Stagebox	Allen&Heath DX168/X	16 x XLR in 8 x XLR out	
2	DI- Box	Palmer Audionomix PAN02		
1	Portable Recorder	Tascam DR-44WLB	2x mic/line in SD/SDHC/SDXC card	
1		PC + Ableton Live 11		

### Microphones

6	Digital UHF Receiver + Pocket Transmitter	Shure QLXD4		
2	Handheld	Shure QLX D/ SM58	cardoid	dynamic
2	Headset	Shure Beta 53	omnidirectional	condenser
4	Lavalier	Shure DL4C	omnidirectional	condenser
2	Handheld	Shure SM58	cardoid	dynamic
1	Handheld	Sennheiser e845	supercardioid	dynamic

### PA

#### Fixed Installation

2	Active Full- Range Speaker	JBL EON 15	ceiling- mounted; front edge of the stage	
2	Active Full- Range Speaker	JBL EON 610	on stage, front fill	
2	Sub	JBL EON 15	under stage	
2	Active Near Field Monitor	JBL 308P MKII	gallery	
2	FOH Monitor			

### Monitoring

4	Active Full- Range Speaker	JBL EON 610		
---	----------------------------	-------------	--	--

### Hardware etc.

6	stand L			
2	stand M			
2	stand XS			
2	music stand			

Lighting + Video Equipment				
qty	type	item	source	color/ temp.
1	Mixer + Fader Wing	ETC ION XE		
42	LED Fresnel + Barndoor	Robert Juliat Sully 305lf WW	LED 115W	WW/ 3000K
3		ETC ColourSource Spot Jr.	LED 162W	RGBL
8	LED PAR	Elation KL PAR FC RGBMA	LED 280W	RGBMA
6	Akku LED PAR	Litecraft BX.7		RGBW
1	Mirror Ball+ Motor (2 directions)	D500mm MBM40 DMX		

Video Equipment				
1	Laser Projector	NEC PUL506 WUXGA		
1		PC + Resolume		

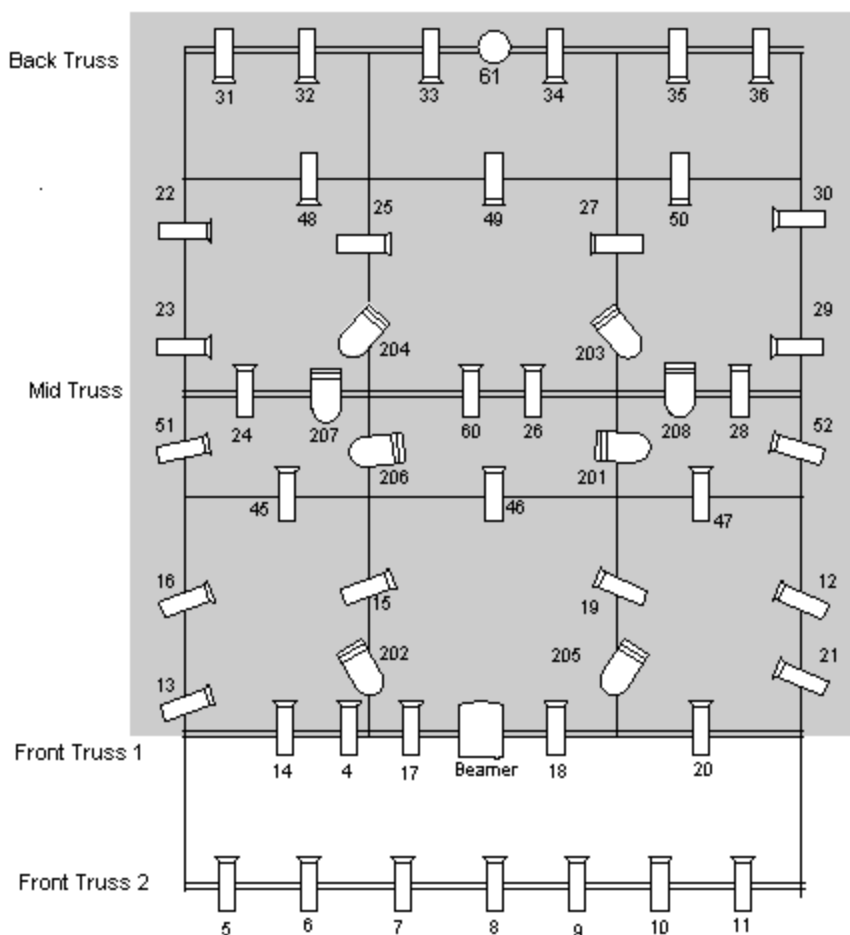

Sully 305 LF WWV



Elation KL PAR FC



ETC Color Spot Jr.



Mirror Ball Ø500mm motorized



NEC PUL506 WJXGA Laserprojektor



Pipe

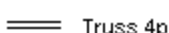

Truss 4p